

SEALS REPAIR KIT SRK250ANO *Humphrey*

KILGORE AT SPRINKLE ROAD
KALAMAZOO, MICHIGAN 49003

REPAIRS SEALS ON ANY:
250A NORMALLY OPEN
*250-4A OR *250-4AA
*REPAIRS NORMALLY OPEN SIDE ONLY

141-5

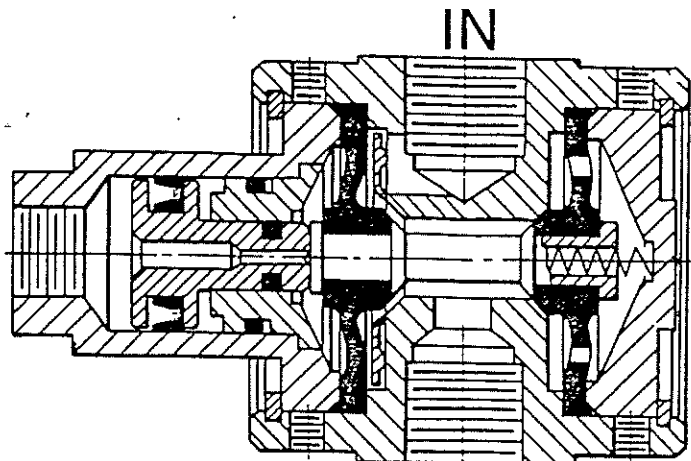

CYL

LETTERED PARTS (A) (B) (C) ETC. IN KIT

NUMBERED PARTS (1) (2) (3) ETC. NOT IN KIT

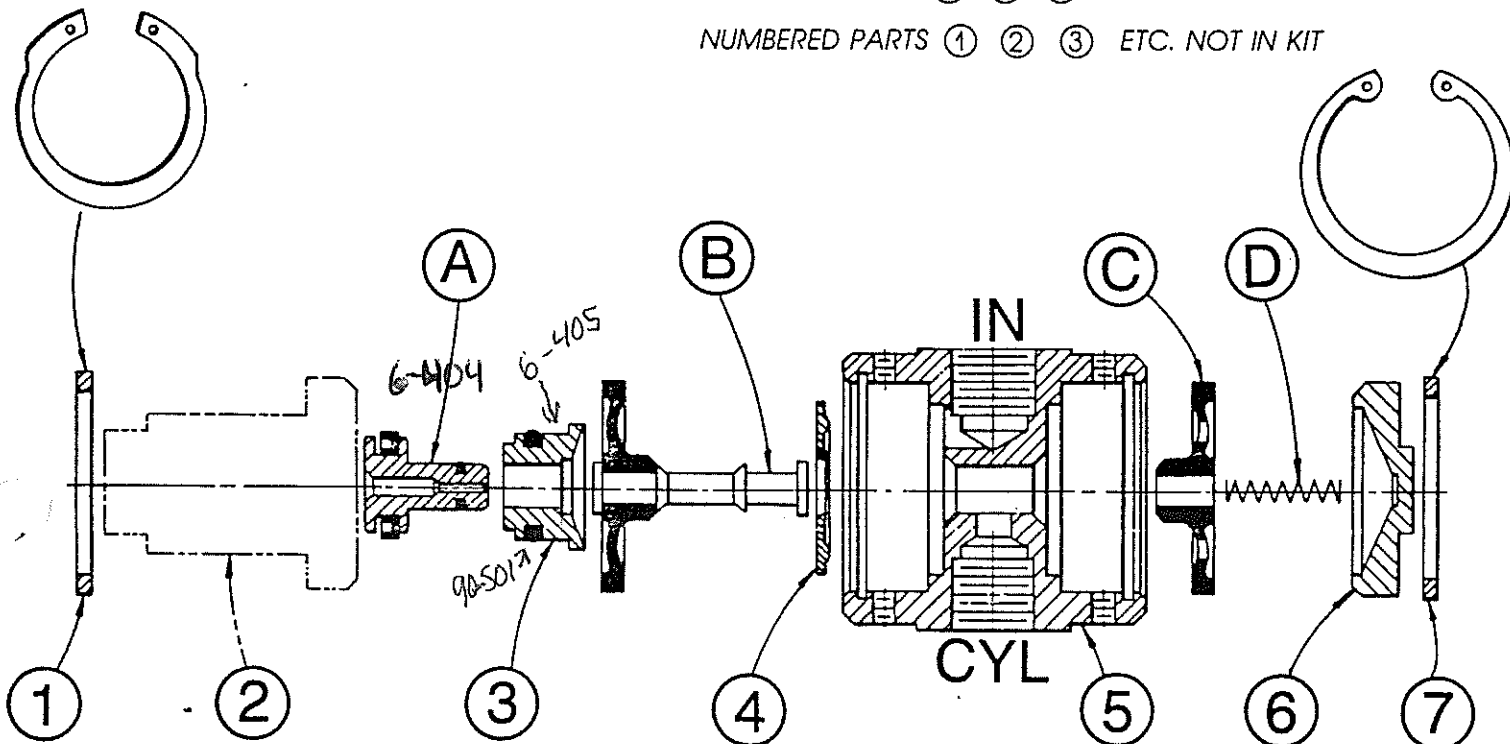

DISASSEMBLY PROCEDURE

1. Remove Retaining Ring 7, End Cap 6 and Spring D.
2. Remove Diaphragm C as SHOWN.

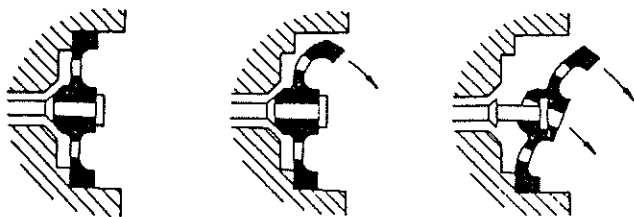

3. Remove Retaining Ring 1, and Actuator 2.
4. Model 250-4A and 250-4AA ONLY. Remove 4 screws and Actuator 2 casting.
5. Remove Piston Guide 3 and Piston Assembly A from Actuator 2.
6. Remove Main Stem and Diaphragm Assembly B NOTING relationship to "IN" port to insure correct reassembly.
7. Remove Support Washer 4 from Body 5.

REASSEMBLY PROCEDURE

1. Place Support Washer 4 in Valve Body 5 with dimples down and straddling "IN" hole.
2. Insert New Main Stem and Diaphragm Assembly B in Valve Body 5 in correct relationship to "IN" port.
3. Assemble Diaphragm C to Main Stem as SHOWN.

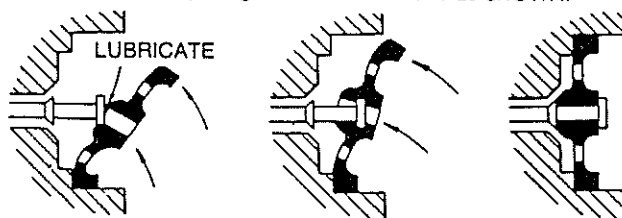

4. Add New Spring D, End Cap 6 and Retaining Ring 7.
5. Lubricate and Assemble New Piston Assembly A and Piston Guide 3 to Actuator 2.
6. Assemble Actuator 2 to Valve Body 5 with Retaining Ring 1. Model 250-4A and 250-4AA ONLY - Assemble Actuator 2 to Valve Body 5 with 4 screws.

NOTE: For 250-4A and 250-4AA ONLY. This kit Repairs Normally Open Side Only — Order SRK 250A to repair closed side.